

FINAL PLAT BELMONT RIDGE II

A PLANNED UNIT DEVELOPMENT
 AN ADDITION TO THE CITY OF EDMOND,
 PART OF THE SW 1/4, SECTION 11, T.14N., R.3W., I.M.
 OKLAHOMA COUNTY, OKLAHOMA

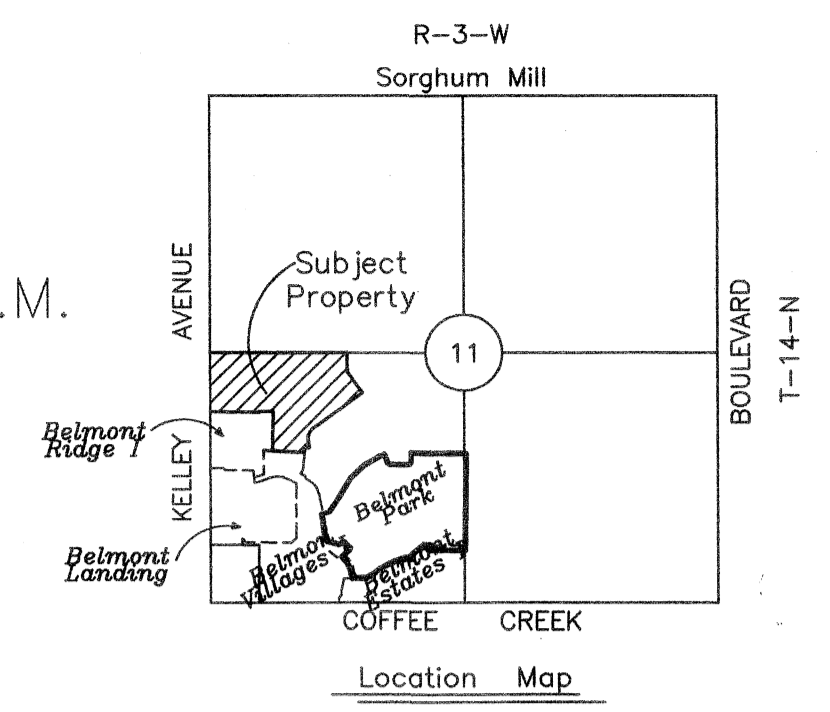

Sun Country Homes, L.L.C.
 BONDED ABSTRACTOR'S CERTIFICATE

The undersigned duly qualified and lawfully bonded abstractor of titles in and for the County of Oklahoma, State of Oklahoma, hereby certifies that the records of said County show that the title to said land shown on the annexed plat of BELMONT RIDGE II, and being a part of the SW 1/4 of Section 11, T14N, R3W, I.M., Oklahoma County, Oklahoma, is vested in ~~Sun Country Homes, L.L.C.~~, an Oklahoma Limited Liability Company, and that on this 5th day of MAY, 2008, there were no actions pending, or judgments of any nature in any Court, or on file with any Clerk of any Court in said County and State against said land or the owner thereof, and that the taxes are paid for 2007, and prior years, and that there are no outstanding tax sale certificates, tax deeds outside the chain of title relied on and that there are no liens, mortgages, easements, rights of way, oil and gas leases and mineral conveyances except those of record.

BY: Eric R. Offen
 AMERICAN EAGLE TRIPLE INSURANCE
 ERIC R. OFFEN, PRESIDENT
 ATTEST: Joe Adkins
 ASST. SECRETARY

COUNTY TREASURER'S CERTIFICATE

I, the undersigned, do hereby certify that I am the duly elected, qualified and acting County Treasurer of Oklahoma County, State of Oklahoma, and that the tax records of said County show all taxes are paid for the year 2007, and prior years, on the land shown on the annexed plat of BELMONT RIDGE II, a subdivision of part of the SW 1/4 of Section 11, T14N, R3W, I.M., Oklahoma County, Oklahoma and that the required statutory security has been deposited in the office of the County Treasurer guaranteeing payment of the current year's taxes.

IN WITNESS WHEREOF, said County Treasurer has caused this instrument to be executed in Oklahoma City, Oklahoma, on this 14 day of MAY, 2008.

COUNTY TREASURER
JERRY STONE, CHIEF DEPUTY

CITY CLERK CERTIFICATE

I, the undersigned, City Clerk of the City of Edmond, Oklahoma, do hereby certify that I have examined the records of said City and find all deferred payments or unmet assessments on special assessments have been paid in full and there is no special assessment procedure now pending against the land shown on the annexed plat of BELMONT RIDGE II being a subdivision of part of the SW 1/4 of Section 11, T14N, R3W, I.M., Oklahoma County, Oklahoma on this 14th day of April, 2008.

Betty Brinkman
 CITY CLERK - Deputy

CITY PLANNING COMMISSION APPROVAL

I, the undersigned, Chairman of the City Planning Commission of the City of Edmond, Oklahoma, do hereby certify that said Planning Commission duly approved the FINAL PLAT of BELMONT RIDGE II, an addition to the City of Edmond, being a subdivision of part of the SW 1/4 of Section 11, T14N, R3W, I.M., Oklahoma County, Oklahoma, on this 16th day of January, 2007.

Suzy Shank
 CHAIRMAN

APPROVAL OF PLAT AND ACCEPTANCE OF DEDICATION BY CITY COUNCIL

Be it hereby resolved by the City Council of the City of Edmond, Oklahoma, that the annexed plat of BELMONT RIDGE II, a subdivision of part of the SW 1/4 of Section 11, T14N, R3W, I.M., Oklahoma County, Oklahoma, shown hereon is hereby approved and accepted.

ADOPTED by the City Council of the City of Edmond, Oklahoma this 14th day of April, 2008.

DAVID O'Neil
 MAYOR
 CITY CLERK Betty Brinkman
 Deputy

PHASE 2
 Lots 76
 ACRES = 23.76

FINAL PLAT
 BELMONT RIDGE II

ISCH & ASSOCIATES, INC.
 3540 S BOULEVARD - EDMOND - OKLAHOMA 73103
 405 - 348 - 1183
 Certificate of Authorization No. 1139 Exp. Date: 6-30-09



CURVE	RADIUS	DELTA	TANGENT	LENGTH	CHORD	BEARING
C-1	130.56'	65°27'46"	83.93'	149.19'	141.21'	S23°33'34"W
C-2	352.79'	34°38'07"	110.00'	213.26'	210.03'	S16°23'30"E
C-3	142.96'	55°21'53"	75.00'	138.14'	132.83'	S61°23'30"E

OWNER'S CERTIFICATE AND DEDICATION Sun Country Homes, L.L.C.

KNOW ALL MEN BY THESE PRESENTS that the undersigned, ~~BELMONT RIDGE II~~, an Oklahoma Limited Liability Company, hereby certifies that it is the owner of the legal title and the only person, firm, or corporation having any legal right, title or interest in and to the land shown on the annexed map or plat of BELMONT RIDGE II, an addition to the City of Edmond, being a subdivision of part of the SW 1/4 of Section 11, T14N, R3W, I.M., Oklahoma County, Oklahoma, and do further certify:

THAT as the owner of the title to said land which is shown and described on the annexed plat of BELMONT RIDGE II, does hereby dedicate the streets and avenues shown on said map or plat for the uses of the public, their successors and assigns, and guarantees a clear title to said land and has caused the same to be released of all encumbrances so that the title is clear, except as shown in the Bonded Abstractor's Certificate hereon.

THAT the areas indicated on said plat as drainage and utility easements are hereby reserved for the purpose of locating, constructing, erecting, maintaining, conducting and performing any public or quasi-public utility function or service above or beneath the surface of the ground with rights of ingress and egress at any time for the purpose of installation, repair, maintenance, operation and/or removal of any such public or quasi-public utility.

THAT the property platted herewith is subject to and a part of a Property Owners Association comprised of all lot owners within the BELMONT FARMS DEVELOPMENT and that Blocks A through G shown on the Plat of BELMONT RIDGE II is a Common Area to be owned and maintained by said Property Owners Association. Said Common Area has been reserved for landscaping purposes and for other uses as may be determined by said Association.

SAID property covered by this plat and this dedication are subject to certain restrictions, reservations and covenants contained in a separate instrument which may be filed subsequent to the filing of this plat.

IN WITNESS WHEREOF, said Limited Liability Company has caused this instrument to be executed at Edmond, Oklahoma, this 25th day of April, 2008.

M. Manager
 BELMONT RIDGE PROPERTIES, L.L.C., an Oklahoma Limited Liability Company
 Sun Country Homes, L.L.C.

STATE OF OKLAHOMA }
 COUNTY OF OKLAHOMA } SS

Before me, the undersigned, a Notary Public in and for said County and State, on this 25th day of April, 2008, personally appeared Gary Spencer to me known to be the identical person who executed the within and foregoing instrument and acknowledged to me that he executed the same as his free and voluntary act and deed for the uses and purposes therein set forth.

Harold Kotel
 NOTARY PUBLIC

MY COMMISSION EXPIRES:
 COMMISSION # 01002915

SURVEYOR'S CERTIFICATE

I, Robert L. McCutchan, a Licensed Professional Land Surveyor in the State of Oklahoma, do hereby certify that the annexed plat of BELMONT RIDGE II, an addition to the City of Edmond, Oklahoma County, Oklahoma, correctly represents a careful survey made under my supervision, and that the monuments shown thereon actually exist and are correctly shown.

Robert L. McCutchan 4/9/08
 Robert L. McCutchan, L.P.L.S. #153

STATE OF OKLAHOMA }
 COUNTY OF OKLAHOMA } SS

Before me, the undersigned, a Notary Public in and for said County and State, on this 9th day of April, 2008, personally appeared Robert L. McCutchan, to me known to be the identical person who subscribed the name of the maker thereof and that he executed the same as his free and voluntary act and deed for the uses and purposes therein set forth.

Robert L. McCutchan
 NOTARY PUBLIC

MY COMMISSION EXPIRES: 10/25/10
 COMMISSION # 02017996

Notes:

- This Plat meets or exceeds the Minimum Standards for the Practice of Land Surveyors as adopted by the Oklahoma State Board of Registration for Professional Engineers and Land Surveyors; and said Final Plat complies with the requirements of Title 11 Section 41-108 of the Oklahoma State Statutes.
- The Base Line for this Plat is the West Line of the SW 1/4 of Section 11.- N00°55'33"E Basis of Bearings: City of Edmond Datum. GPS Monument Sta. 1194; NAD-83
- Owners of property in Belmont Ridge II will become members of the Homeowners Association of Belmont Farms.
- The Homeowners Association shall be responsible for the maintenance and operation of all Private Drainage Easements and Detention Facilities.

OWNER'S NOTARY

SURVEYOR

SURVEYOR'S NOTARY

ABSTRACTOR

COUNTY

CITY

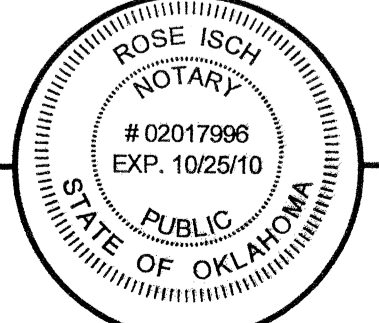
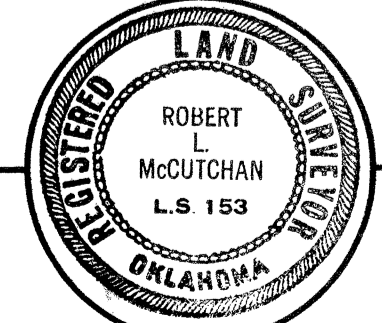

Scale: 1" = 100'